

Flowerona

Inspired by flowers

Joe Swift designs his first garden at the RHS Chelsea Flower Show for Homebase
Author: Rona Wheeldon – Flowerona - 6th March 2012



At the Garden Press Event which took place last month in London, I had the pleasure of meeting and interviewing garden designer, Joe Swift.

Joe is designing the Homebase Teenage Cancer Trust Garden for this year's RHS Chelsea Flower Show.

And here's an overhead view of it...

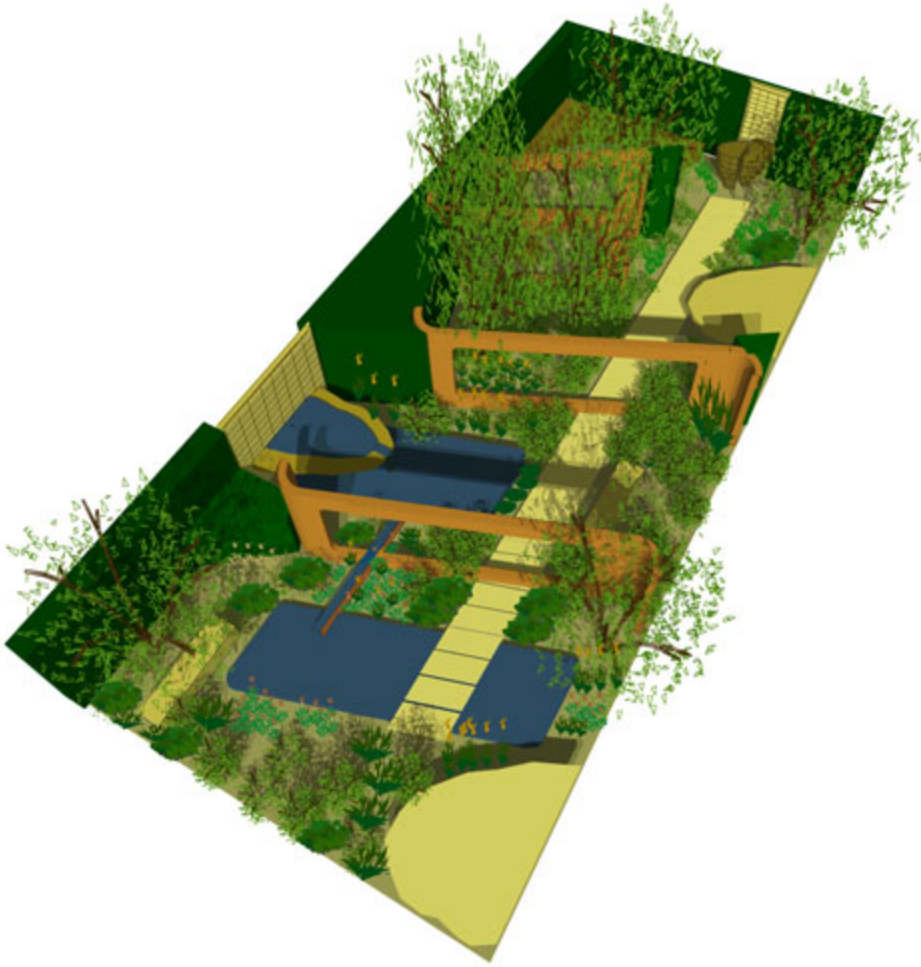

This is the first time that Joe's designed a garden for the show and he said that he feels very excited at the prospect.

His inspiration has been drawn from the contrast of the different areas that he passes in and around London.

Four large warm cedar frames will sit within the garden, dividing it up into distinct rooms, with wooden sculptures and boulders providing seating.

He plans to add texture with his choice of trees...Cornus Mas and Prunus 'Amber Beauty', with their peeling barks.

Even though the plan above looks predominantly full of greenery, he assured me that there will be lots of colourful flowers in his design.

He's planning on using warm tones such as orange, gold and acid green, with splashes of burgundy.

Orange geums will be used to add a vibrant pop of colour, with lots of euphorbia providing the acid green tone.

He also has irises and eremurus being grown for him at the moment, which he said he hopes will flower in time for Chelsea.

In celebration of the Homebase Teenage Cancer Trust Garden, Homebase is launching an exclusive range of plants called 'The Chelsea Collection'.

Included are Oxalis Xalis Burgundy Wine, Erysimum Bowles's Mauve, Euphorbia Purpurea and Photinia Little Red Robin, as pictured below.





The collection will be arriving in Homebase stores soon and the idea is to allow customers to create a piece of the RHS Chelsea Flower Show in their own garden, with specific gardening plans which have also been created by Joe.

And like Joe's design, The Chelsea Collection will match warm colour tones against green foliage.

I very much look forward to seeing Joe's design at the RHS Chelsea Flower Show which takes place from May 22nd to 26th.

Link to original publication:

<http://flowerona.com/2012/03/joe-swift-designs-his-first-garden-at-the-rhs-chelsea-flower-show-for-homebase/>